



DISCLAIMER

Every effort has been made to ensure the accuracy of all information contained on this floorplan. However, no warranties, either expressed or implied, are made with respect to this floorplan. If the location of building columns, utilities or other architectural components of the facility is a consideration in the construction or usage of an exhibit, it is the sole responsibility of the exhibitor to physically inspect the facility to verify all dimensions and locations. © Copyright 1998, Freeman Decorating Co. All rights reserved.

LEGEND

- [FHC] - FIRE HOSE CABINET - MUST REMAIN CLEAR
- CEILING HEIGHT #
- DF - DRINKING FOUNTAIN
- PH - PHONE
- E - ELECTRICAL OUTLET
- FLOOR LOAD # PER SQ. FT.
- MALL FLOOR LOAD # PER SQ.FT.

40 - 8X10 BOOTHS = 3200 SQ.FT.
 3 - 10X6 BOOTHS = 180 SQ.FT.
 TOTAL SQUARE FOOTAGE: 3380 SQ.FT.

EXHIBIT HALL FLOOR PORT LEGEND

- ▣ ELECTRICAL SERVICE FLOOR PORT
 - 3 - 120V 15 AMP. RECEPTACLES
 - 2 - TELEPHONE JACKS
- ▣ ELECTRICAL SERVICE FLOOR PORT
 - 1 - 480V 100 AMP. RECEPTACLE
 - 3 - 120V 15 AMP. RECEPTACLES
 - 1 - 208V 60 AMP. RECEPTACLE
 - 2 - TELEPHONE JACKS
- ▣ MECHANICAL SERVICE FLOOR PORT
 - 4" DRAIN
 - 1" DOMESTIC WATER 60 PSI (35 GPM)
 - 1" NATURAL GAS 1 PSI (27 WC)
 - 1" COMPRESSED AIR 100 PSI (180 CFM)
- ▣ MECHANICAL SERVICE FLOOR PORT
 - SAME AS ABOVE PLUS:
 - 2" STEAM
 - RETURN CONDENSATION 1-1/4"
 - 100 PSI

SCALE



SHOW: DENVER XRAY CONF.	RVSD:	
HALL: BALLROOM, FOYER	0000	
SHOW DATE: 07/30-08/02/2001		
FILE NAME: DXC073001.dwg		
JOB #: 021471		
START: 02/23/01		
SCALE:		
DRAWN BY: KCULKIN		

THE Freeman
 Denver COMPANIES

8500 Stapleton Drive South
 Denver, CO 80216

Phone: (303) 529-3442
 Fax: (303) 529-3850

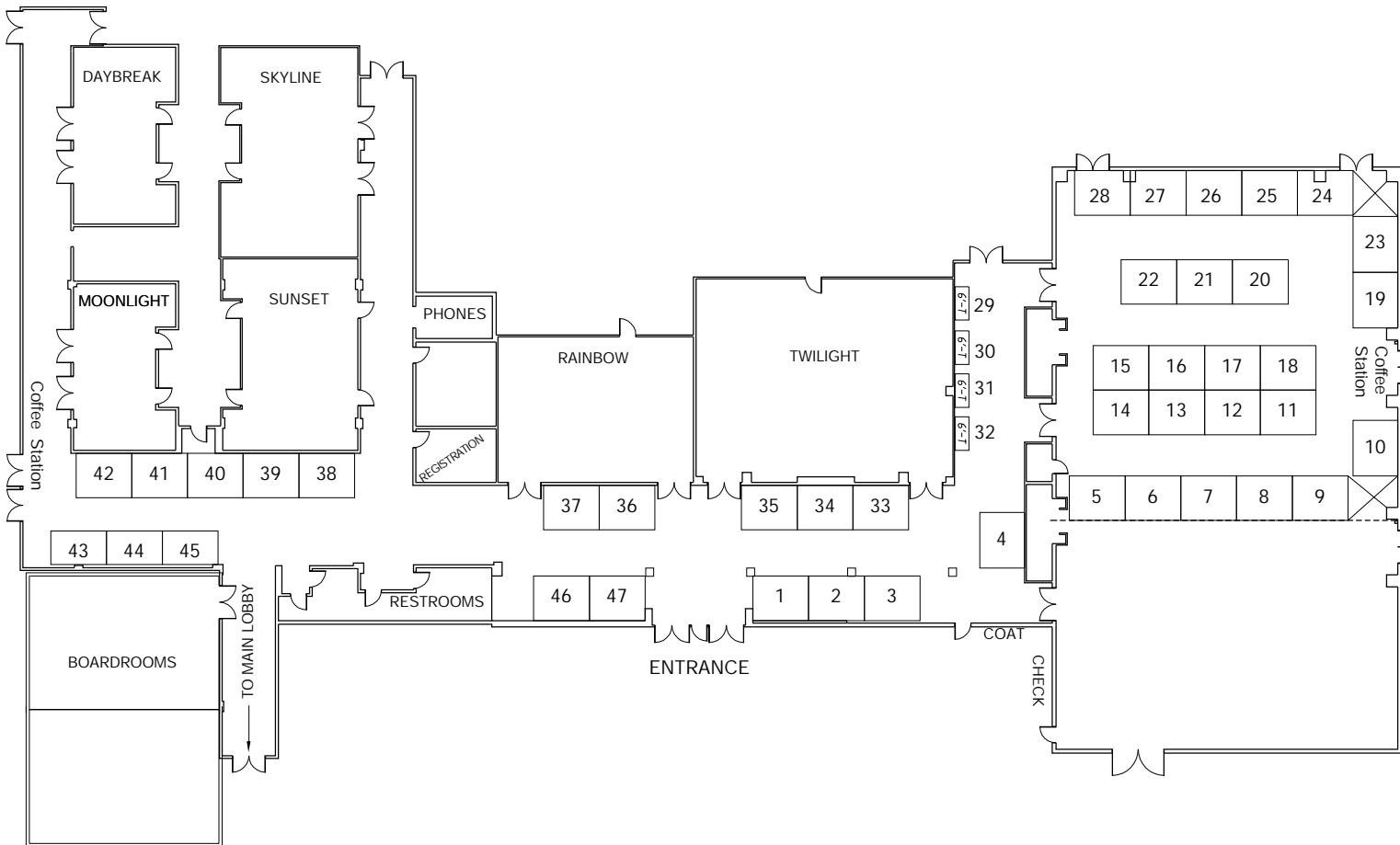

**DENVER X-RAY
 CONFERENCE
 JULY 30 - AUG. 2, 2001**

**SHERATON HOTEL,
 GRAND BLRM.,FOYER,MTG. RMS.
 STEAMBOAT SPRINGS,CO**